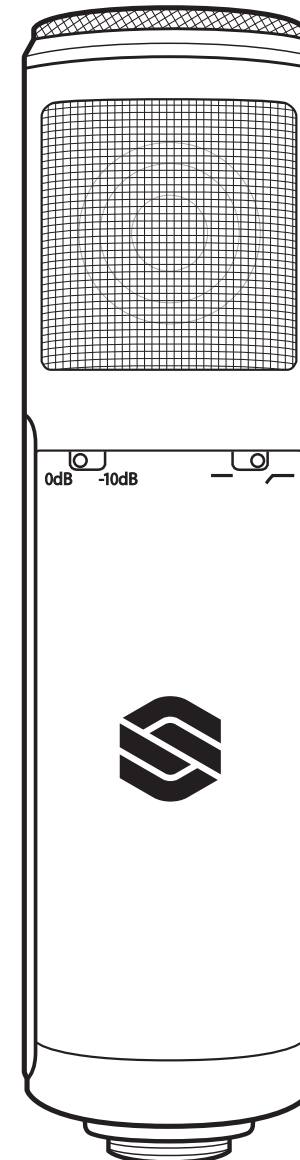

ST169 Multi-Pattern Tube Condenser Microphone

OWNER'S MANUAL
PRODUCT SPECIFICATION

Circuit Type	Class A Tube
Polar Pattern	Cardioid, Omni, Figure-8
Frequency Response	20–20kHz
Switchable Hi-Pass Filter	75Hz, 12dB/octave
Switchable Attenuation Pad	–10dB
Maximum SPL	142dB (132dB without pad)
Sensitivity	32mV/Pa
Equivalent Noise Level A-Weighted	.22dB SPL
Typical Load Impedance	>1000 Ω
Output Source Impedance	200 Ω Transformer Isolated
Power Supply	Included PSM169 Power Supply
Microphone Dimensions	7.7" long, 1.9" max. diameter
Microphone Weight	1.2 lbs
Included Accessories	SM8 Shock Mount, EC7 7-pin XLR Cable, Power Cord, PSM169 Power Supply, Aluminum Case

RECORDING TIPS: www.sterlingaudio.net

HAVE QUESTIONS?

**MISSING
OR
DAMAGED
PARTS?**

CALL
888-621-2154
TOLL FREE

**HAVE
ASSEMBLY
QUESTIONS?**

OR VISIT OUR WEBSITE AT: STERLINGAUDIO.NET

Sterling Audio

P.O. Box 5111

Thousand Oaks, CA 91359-5111

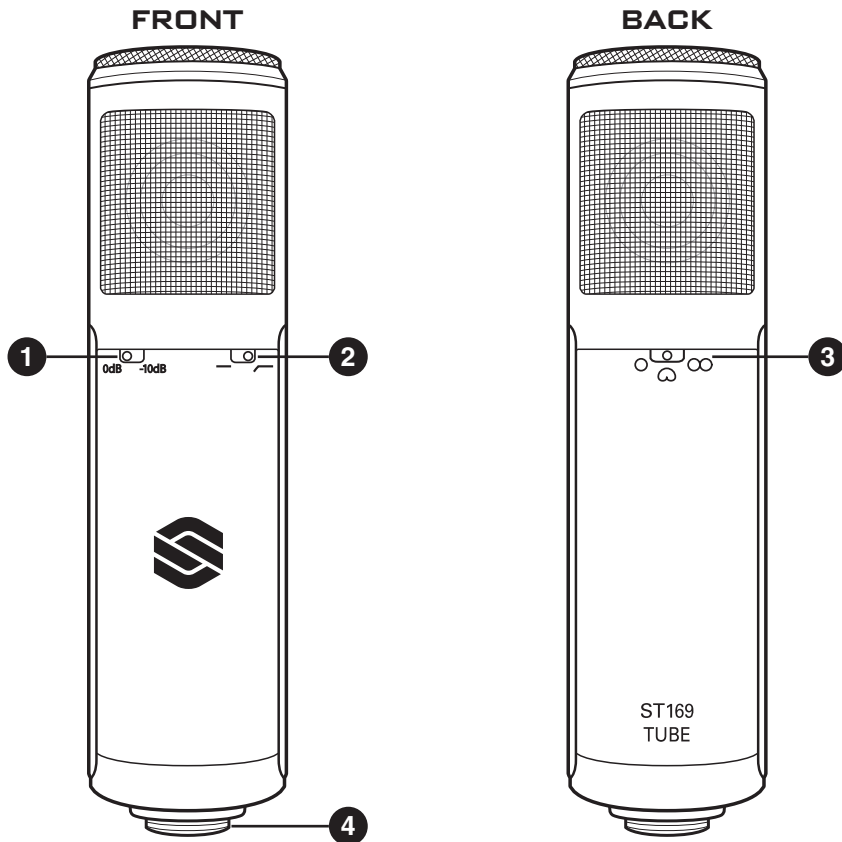

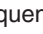
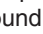
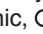
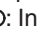
- 1 -10dB Pad**
Reduces volume: Set to -10dB only if source is too loud for your preamp.
- 2 Low Cut (-12dB/octave @ 75Hz)**
Reduces very low frequencies: Set to  except for bass, kick drum or similar sources.
- 3 Polar Pattern Selector**
Determines whether audio is primarily captured from
: In front of mic, : All around mic, : In front of and behind mic.
- 4 PSM169 Power Supply**
Connect included 7-pin cable from power supply to microphone, turn on PSM169. Connect standard mic cable from PSM169 to your audio input.

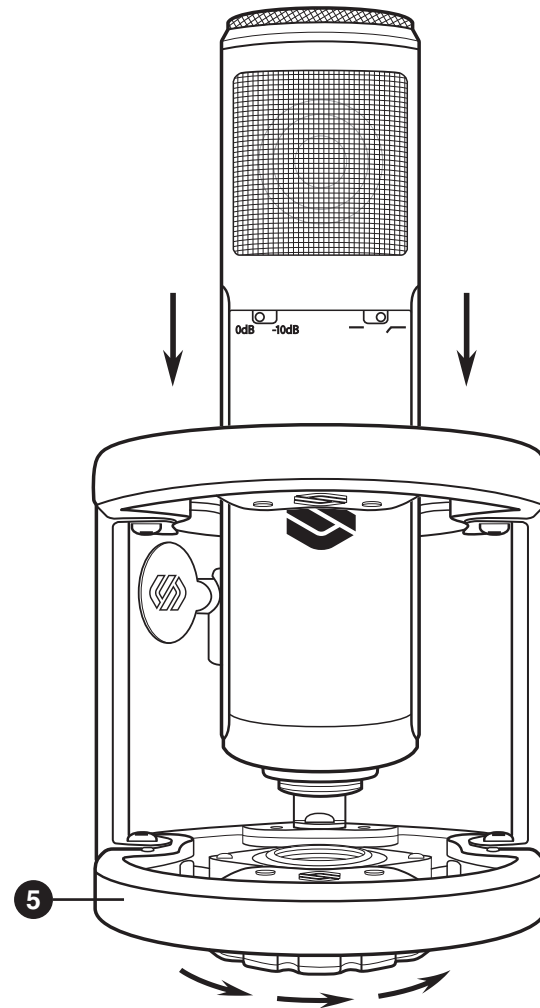

- 5 SM8 Shock Mount**
Mic end threads into mount: secure mic by spinning dial at bottom of mount until it stops.