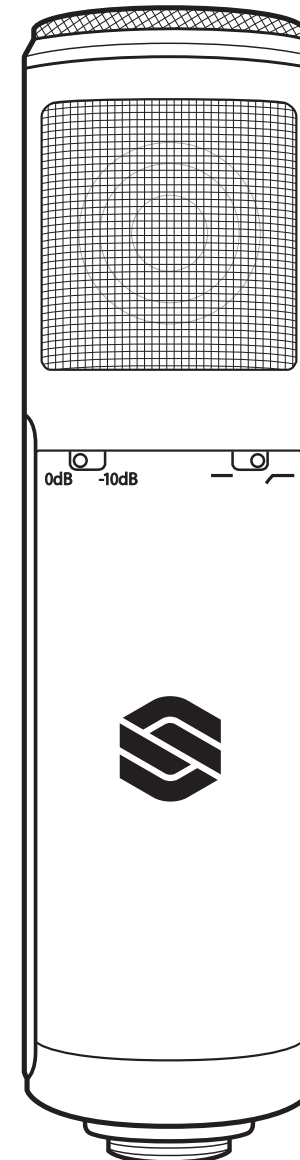

ST159 Multi-Pattern Condenser Microphone

OWNER'S MANUAL
PRODUCT SPECIFICATION

Circuit Type	Class A FET
Polar Pattern	Cardioid, Omni, Figure 8
Frequency Response20–20kHz
Switchable Hi-Pass Filter	75Hz, 12dB/octave
Switchable Attenuation Pad	–10dB
Maximum SPL	144dB (134dB without pad)
Sensitivity	32mV/Pa
Equivalent Noise Level A-Weighted22dB SPL
Typical Load Impedance	>1000 Ω
Output Source Impedance	200 Ω Transformer Isolated
Power Supply	+48V Phantom Power Required
Microphone Dimensions	7.7" long 1.9" max diameter
Microphone Weight	1.3 lbs.
Included Accessories	SM8 Shock Mount, Aluminum Case

RECORDING TIPS: www.sterlingaudio.net

HAVE QUESTIONS?

**MISSING
OR
DAMAGED
PARTS?**

CALL
888-621-2154
TOLL FREE

**HAVE
ASSEMBLY
QUESTIONS?**

OR VISIT OUR WEBSITE AT: STERLINGAUDIO.NET

Sterling Audio

P.O. Box 5111
Thousand Oaks, CA 91359-5111

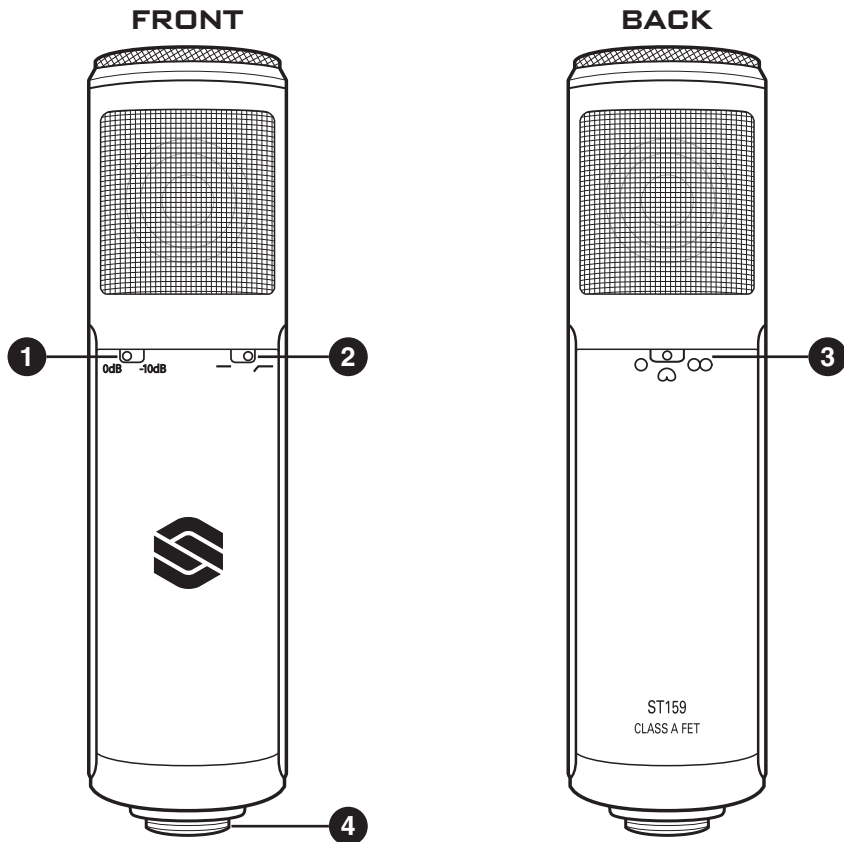

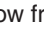
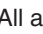
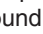
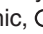
- 1 -10dB Pad**
Reduces volume: Set to -10dB only if source is too loud for your preamp.
- 2 Low Cut (-12dB/octave @ 75Hz)**
Reduces very low frequencies: Set to  except for bass, kick drum or similar sources.
- 3 Polar Pattern Selector**
Determines whether audio is primarily captured from
: In front of mic, : All around mic, : In front of and behind mic.
- 4 Audio**
Connect standard mic cable.

Phantom Power (48v) Required

These mics require phantom power from your preamp, audio interface or mixer. Avoid pops: make cable connections first, THEN activate 48v.

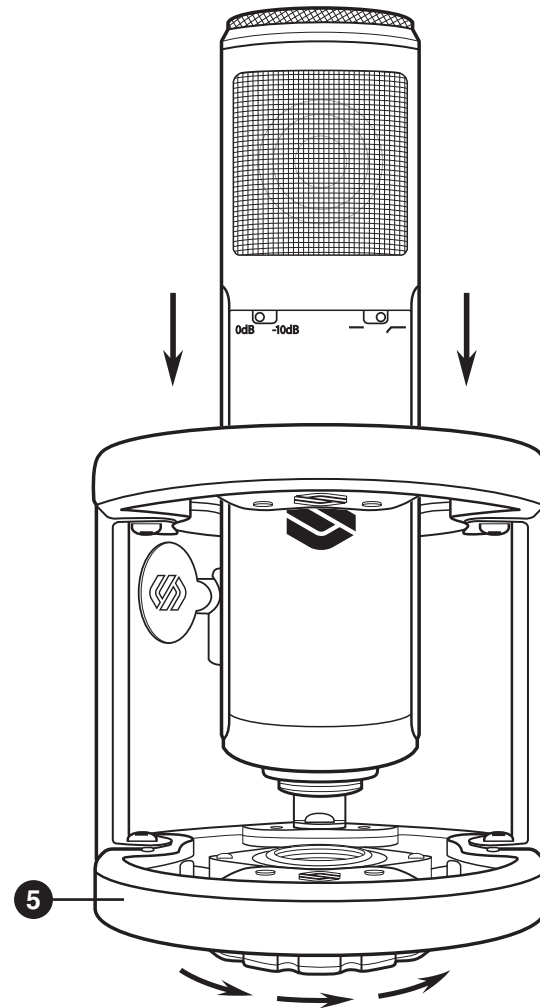

- 5 SM8 Shock Mount**
Mic end threads into mount: secure mic by spinning dial at bottom of mount until it stops.